

70-B-54 - SPEEDLINE System Data Sheet - Version V1 (24-10-23)

SPEEDLINE 70mm 'C' Stud Partition @600mm Ctrs,
with BG Gyproc 15mm SoundBloc each side

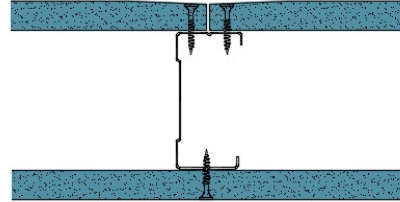

System Performance Breakdown

Fire Resistance:

BS476 Part 22:1987:

Test Ref & Date or Applied Ref & Report:

Max Height:

Thickness:

Duty Grade: BS 5234: Part 2:1992:

Sound Insulation:

30/30 Minutes (Integrity/Insulation).

BTC 17439F - BRE Report P102396-1011A

Refer to Speedline Specification Clause

102 mm. (At Base Track, Excluding Finishes)

Heavy - Annexes A-F

42 $R_{w,dB}$, Date Tested or Assessed Against - 15/07/2011

Test Code:
H17488AA
Test Date:
15/07/2011

Freq. Hz	R dB
50	22.0
63	14.2
80	10.2
100	15.5
125	17.1
160	28.7
200	36.3
250	36.9
315	37.0
400	41.4
500	46.3
630	48.8
800	54.4
1 000	56.2
1 250	58.1
1 600	57.3
2 000	47.6
2 500	39.6
3 150	43.2
4 000	46.1
5 000	49.8
6 300	
8 000	
10 000	

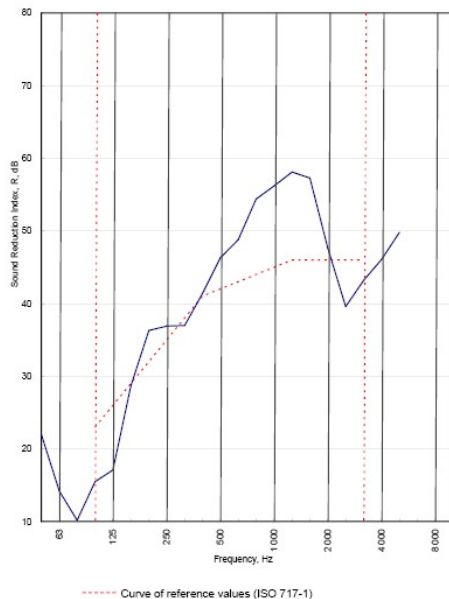

Rating according to BS EN ISO 717-1:1997
 $R_w (C;Ctr) = 42 (-3;-9) dB$
 Max dev. 8.9 dB at 125 Hz

Evaluation based on laboratory measurement results obtained by an engineering method:	$C_{50-3150} = -5 dB$	$C_{50-5000} = -4 dB$	$C_{100-5000} = -2 dB$
	$C_{2-50-3150} = -14 dB$	$C_{2-50-5000} = -14 dB$	$C_{2-100-5000} = -9 dB$

TESTED AT ONE OF THE UKAS ACCREDITED LABORATORIES BELOW

- B.T.C (H-Ref on Graph)
- B.R.E
- AIRO
- S.R.L

Customer: Metsec plc Hepsec Division



BTC 17488A: Page 8 of 10

SPEEDLINE Drywall Systems, Adsetts House, 16 Europa View, Sheffield Business Park, Sheffield, S9 1XH.

Tel: 0114 231 8030.

Email: enquiries@speedlinedrywall.co.uk

(As per the requirements set out in ISO/IEC 17025:2017 regarding test data the results stated have been carried out by voestalpine Metsec plc as part of the contract to supply Speedline Metal Sections to SIG Plc)